

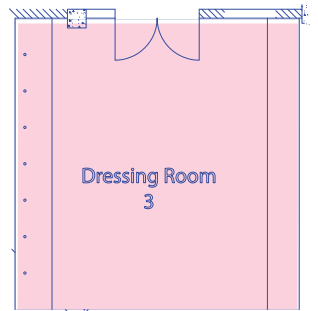

Bottom Floor



DRESSING ROOMS

- Bottom Floor
 - 2 small dressing rooms (4-6 person)
 - 1 dressing large room (10-20 persons)
 - Wardrobe room (also a dressing room - 10-14 persons)

- Main Floor
 - 2 small dressing rooms (4-6 person)
 - (These are either used as dressing rooms or offices for dance groups)

- Top Floor
 - 2 Large dressing rooms (12-16 persons) with 6 showers and 3 toilets
 - 1 large dressing / Make up/ Hair station room (20-25 persons)
 - 1 small dressingroom/ office (2-6 persons)
 - Green room (restricted to adults only, no children allowed)